

Connecting Public Health and Food Sector Collaborators: Healthy Menu Innovations in Schools

January 11, 2018

11 AM – 12 PM Pacific

2 PM – 3 PM Eastern

Please close all applications except WebEx.

Audio trouble? Send us a question in the **Q&A** panel.

Technical trouble? Call WebEx at **1-866-229-3239**.

Closed captioning instructions will be provided.

Connect with us on **Twitter** [@Dialogue4Health](https://twitter.com/Dialogue4Health) | **#ReduceSodium**

Audio

Audio is through your computer speakers or headphones

No sound?

→ Unmute and turn up your speaker volume

Still no sound? Call in.

→ Click the small telephone icon in the Participants panel to see dial-in information

Closed Captioning

To see real-time closed captioning:

1. Click to open **Media Viewer**



2. Click **Show/Hide Header**

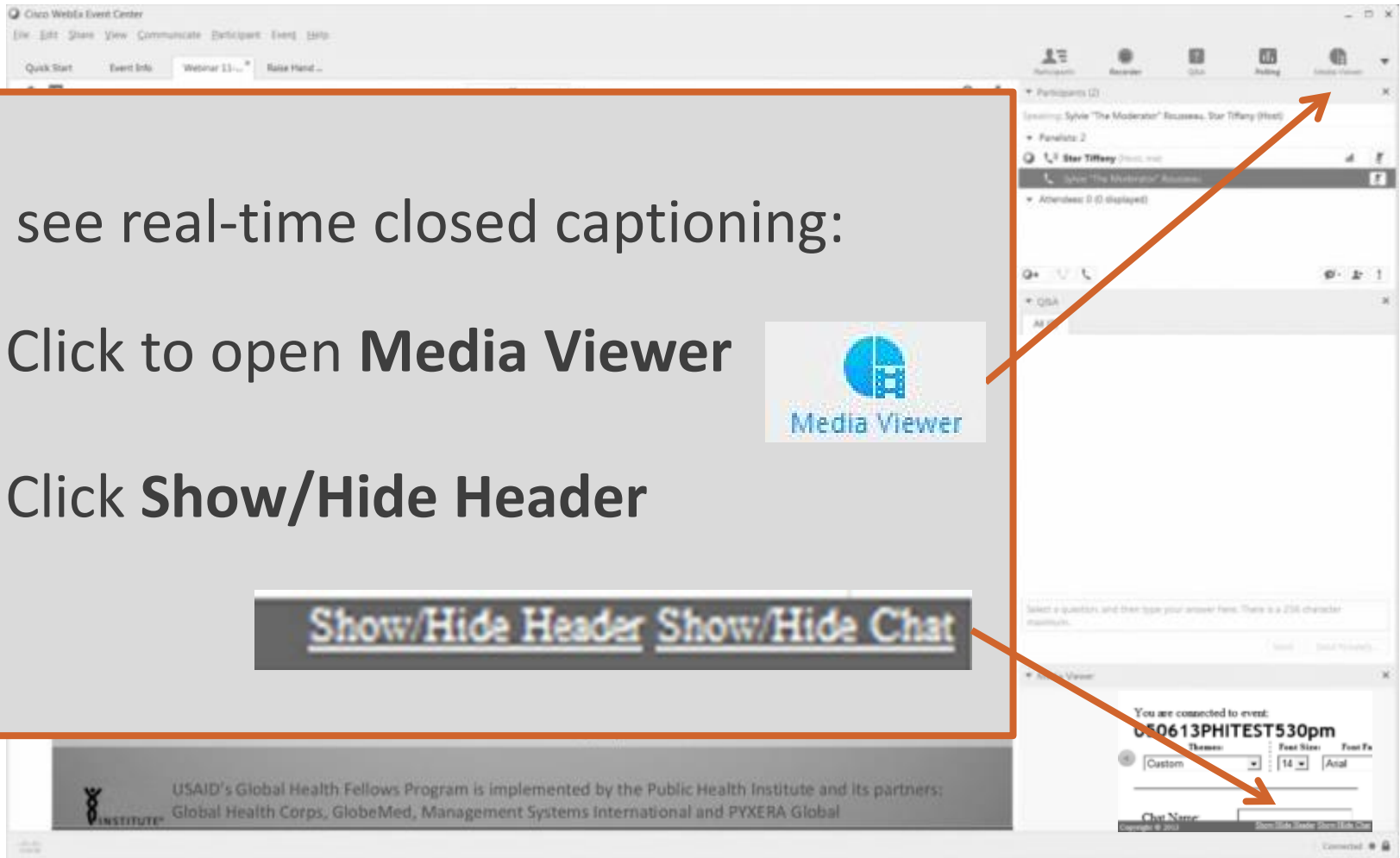
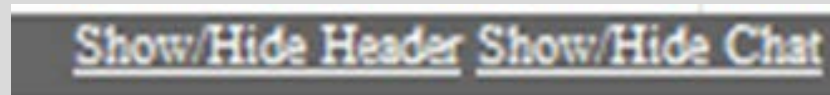

Q&A Feature

1. Type your question in the **Q&A box**
2. Select **Ask: All Panelists**
3. Click **Send**

The screenshot displays the Zoom meeting interface with the Q&A feature highlighted. In the top navigation bar, the 'Q&A' icon is circled in orange. Below this, the 'Q&A' dropdown menu is also circled in orange, showing 'All (0)'. At the bottom of the interface, the 'Ask' dropdown menu is circled in orange, showing 'All Panelists' selected. A 'Send' button is visible next to the question input field.

Polling Feature

Please:

1. Choose your **answer**
2. Click **Submit**

Participants Q&A **Polling**

Participants (3) Q&A Polling

Time elapsed: 0:46 Time limit: 1:30

Poll Questions:

1. Are you attending this Web Forum:

- a. Individually
- b. In a group of 2-5 people
- c. In a group of 6-10 people
- d. In a group of more than 10 people

Submit

Your answer may be recorded.

Poll #1

Are you attending this Web Forum:

- A. Individually
- B. In a group of 2-5 people
- C. In a group of 6-10 people
- D. In a group of more than 10 people



Kelly Hughes, MPH, RD, CHES

Associate Director of Program Strategy
National Network of Public Health Institutes

nnphi.org

About the Audience: Where You Are

- In 48 US states, Washington DC, Canada, and Indonesia
- These states more than 5 audience members:

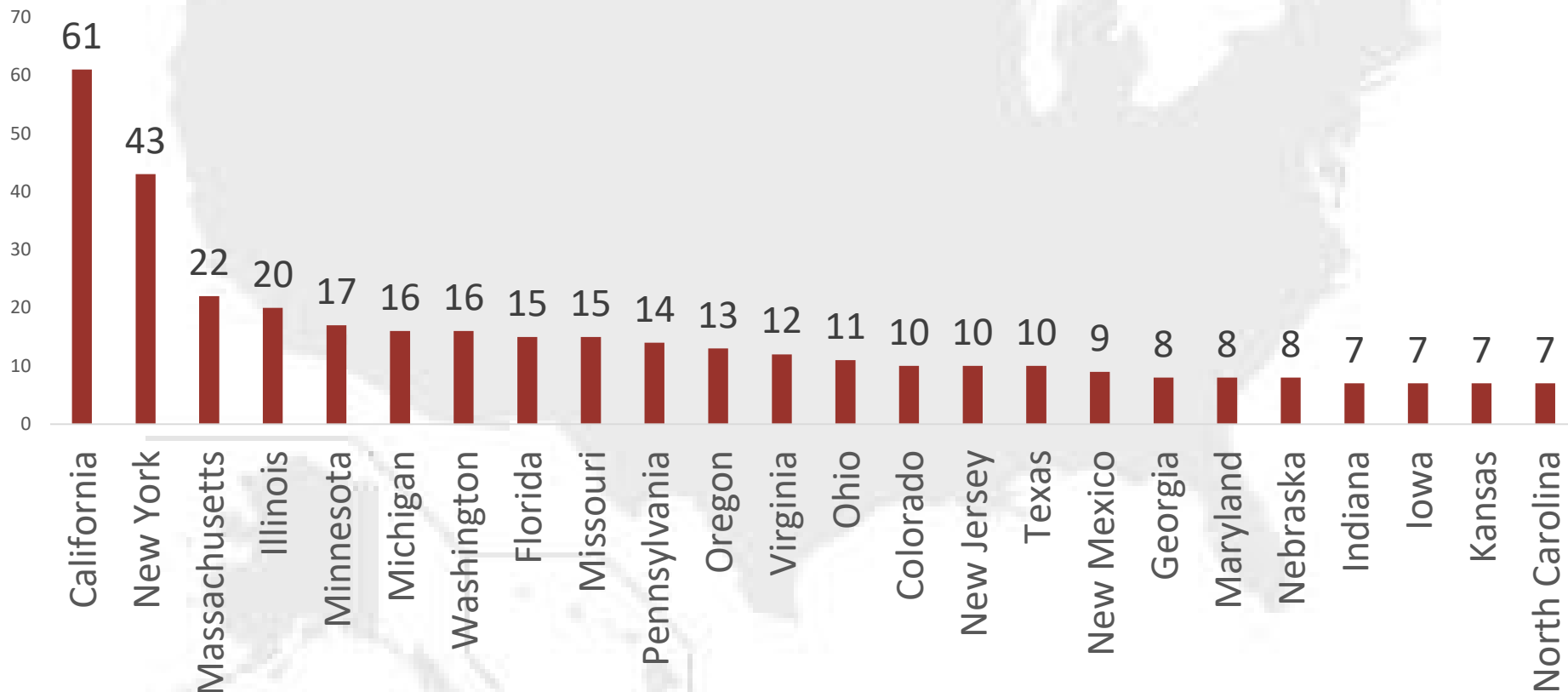

About the Audience: Work Sectors

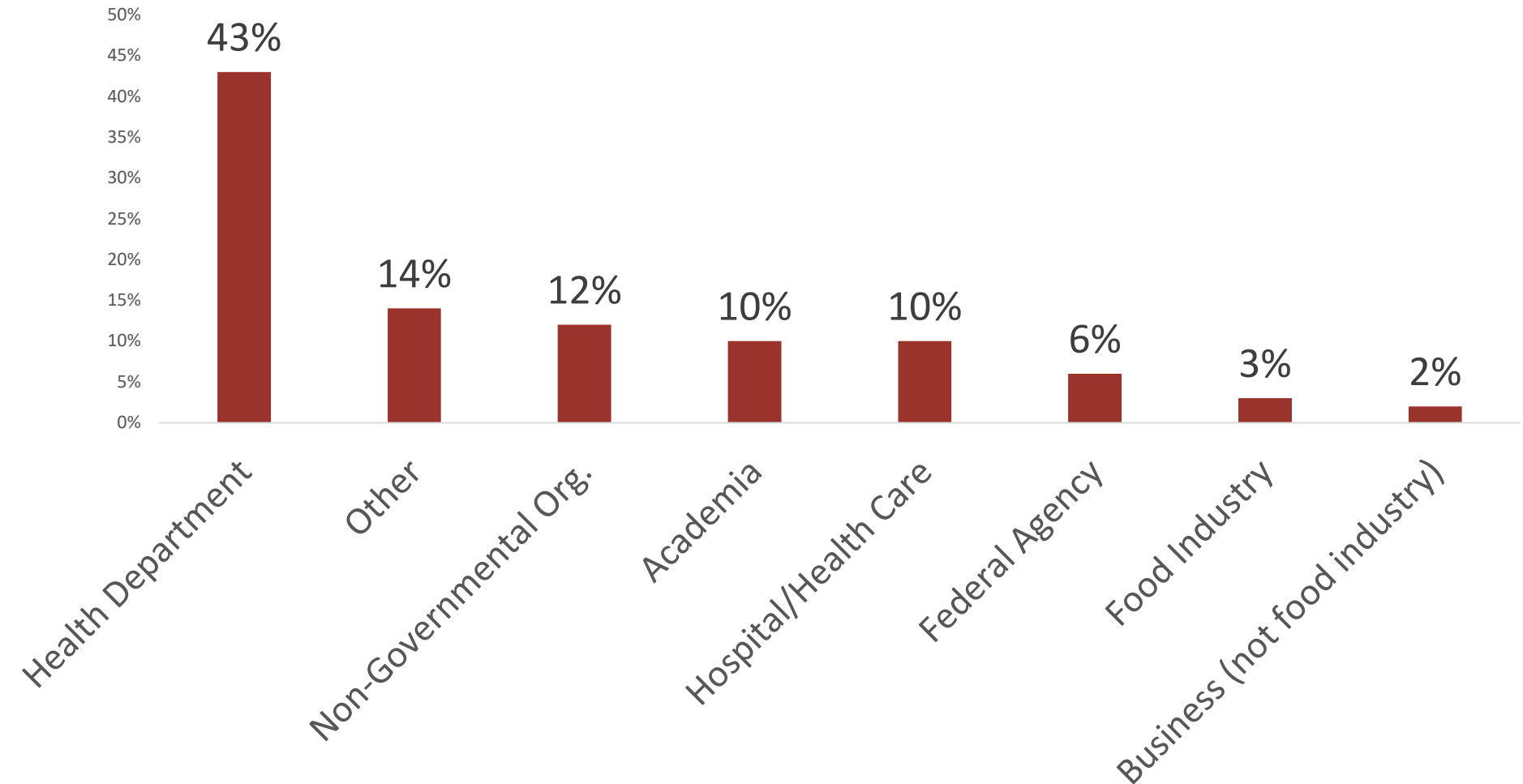



Madelyn Herzog

School Programs Coordinator
Healthy Chelsea



Scott Richardson, MBA

Co-founder & Partner
Northbound Ventures, LLC

northboundventures.com

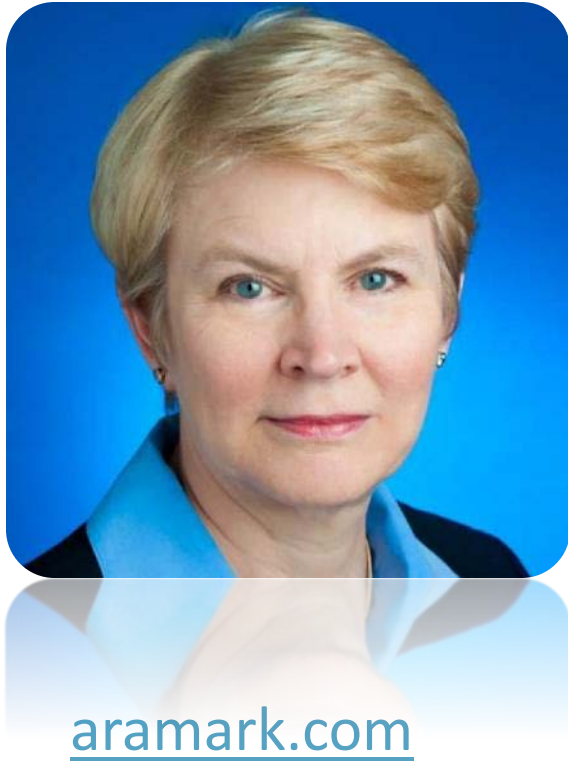

Linda Scurman, MS, RDN, LDN

National Director of Nutrition, K12

Education

Aramark

Poll #2

If you changed your eating and activity patterns what was the primary reason for these changes?

- A. Improve overall health
- B. Feel better
- C. Diagnosed with a health condition
- D. Lose weight
- E. Other

Poll #3

What of the following are functional properties of salt in food systems? (Check all that apply)

- A. Flavor
- B. Flavor Enhancer
- C. Preservative
- D. Texture Enhancer
- E. Nutrient Source
- F. Binder

Q&A Feature

1. Type your question in the **Q&A box**
2. Select **Ask: All Panelists**
3. Click **Send**

The screenshot displays a meeting control interface. At the top, there are three main icons: 'Participants' (a person icon), 'Q&A' (a question mark icon), and 'Polling' (a bar chart icon). The 'Q&A' icon is circled in orange. Below this is a 'Participants (3)' dropdown menu. The main area shows 'Speaking:' followed by 'Panelists: 2' and 'Attendees: 1 (1 displayed)'. The 'Attendee View (me)' section is visible. At the bottom, there is a 'Q&A' panel with a dropdown menu set to 'Q&A' (circled in orange) and a 'Send' button. Below the dropdown, the text 'Ask: All Panelists' is shown, with 'All Panelists' circled in orange. A 'Send' button is also present next to the dropdown. Arrows from the text instructions point to the 'Q&A' icon, the 'Q&A' dropdown, and the 'All Panelists' selection.

Thank you to our panelists!



**Kelly
Hughes**



**Madelyn
Herzog**



**Scott
Richardson**



**Linda
Scurman**

Thank you!

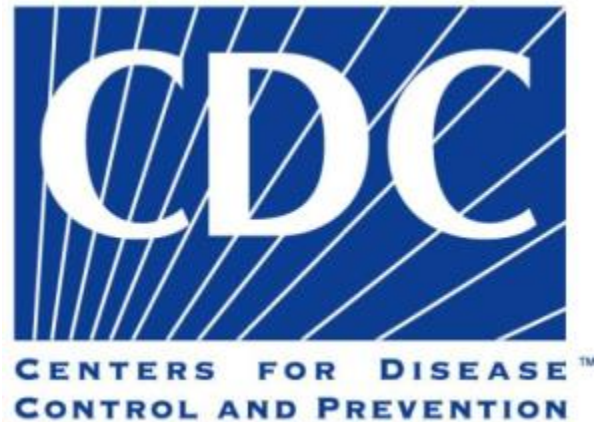

Connecting Public Health and Food Sector Collaborators: Healthy Menu Innovations in Schools

Thank you for joining our Web Forum!

**The recording and slides will be available by next week at
Dialogue4Health.org**

Join the  LinkedIn Group at
tinyurl.com/D4HGroup
