

# Culture of Health Leaders Applicant Web Forum

January 16, 2018

12:30 PM – 1:30 PM Pacific

3:30 PM – 4:30 PM Eastern

---

***Please close all applications except WebEx.***

**Audio difficulties?** Send us a question in the Q&A panel.

**Technical difficulties?** Call WebEx at **1-866-229-3239**.

---

# Closed Captioning

To see real-time closed captioning:

1. Click to open **Media Viewer**



2. Click **Show/Hide Header**

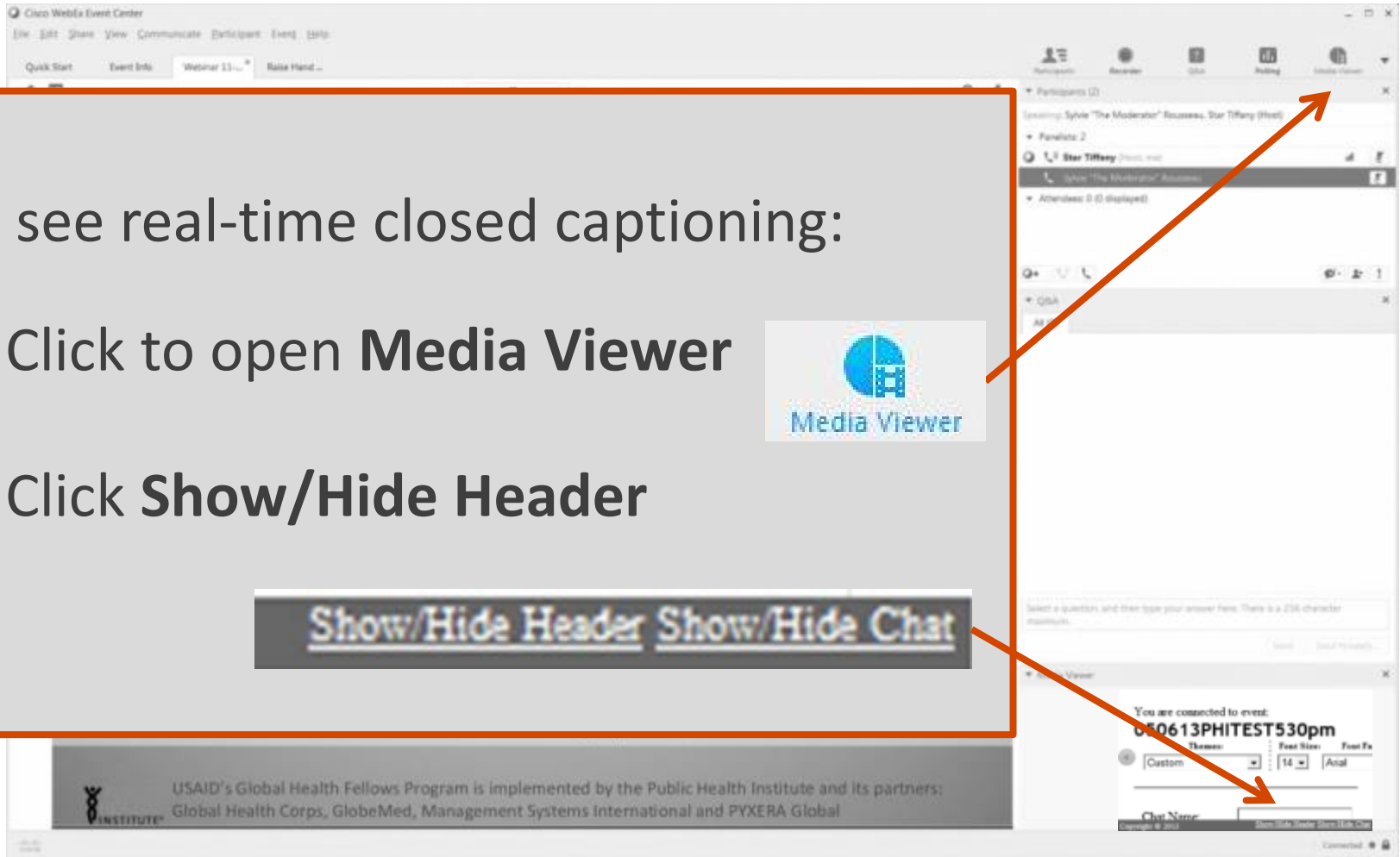
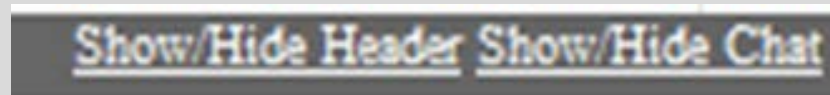

# Audio

**Audio is through your computer speakers or headphones**

No sound?

→ Unmute and turn up your speaker volume

Still no sound? Call in.

→ Click the small telephone icon in the Participants panel to see dial-in information

# Q&A Feature

1. Type your question in the **Q&A box**
2. Select **Ask: All Panelists**
3. Send

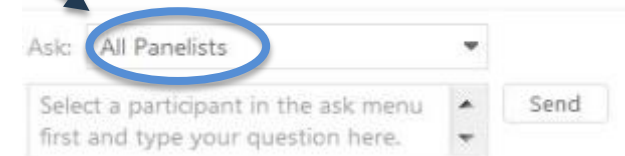
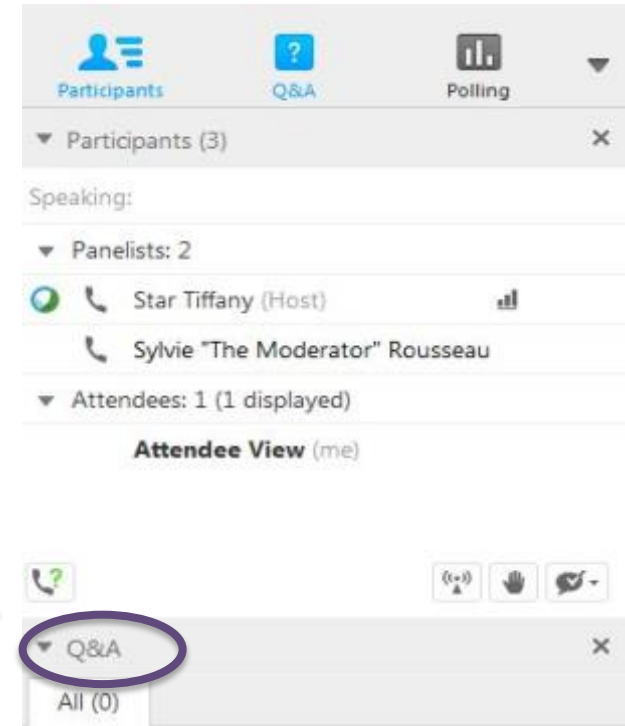

# Polling Feature

Please:

1. Choose your **answer**
2. Click **Submit**

Participants Q&A Polling

Participants (3) ×

Q&A ×

Polling ×

Time elapsed: 0:46 Time limit: 1:30

Poll Questions:

1. Are you attending this Web Forum:

a. Individually

b. In a group of 2-5 people

c. In a group of 6-10 people

d. In a group of more than 10 people

Submit

Your answer may be recorded.

# Poll #1

Are you attending this Web Forum:

- a) Individually
- b) In a group of 2-5 people
- c) In a group of 6-10 people
- d) In a group of more than 10 people



## **Willene Hare**

Program Coordinator

Culture of Health Leaders Program

National Collaborative for Health Equity

[cultureofhealth-leaders.org](http://cultureofhealth-leaders.org)

# About the Audience: Where You Are

- In 48 US states, Washington DC, Puerto Rico, Nigeria, and Malawi
- States with more than 5 registrants are:

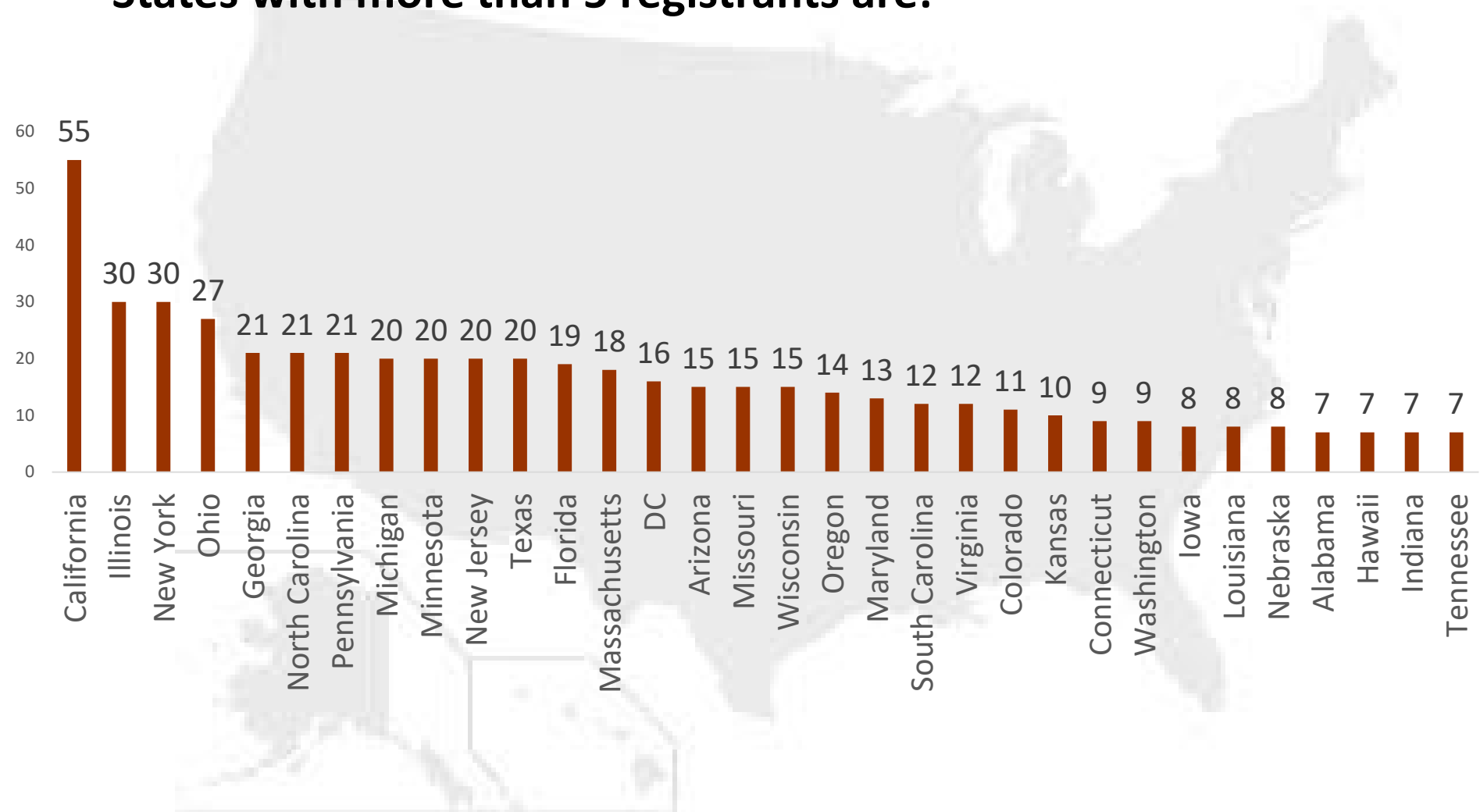



# About the Audience: Work Sectors

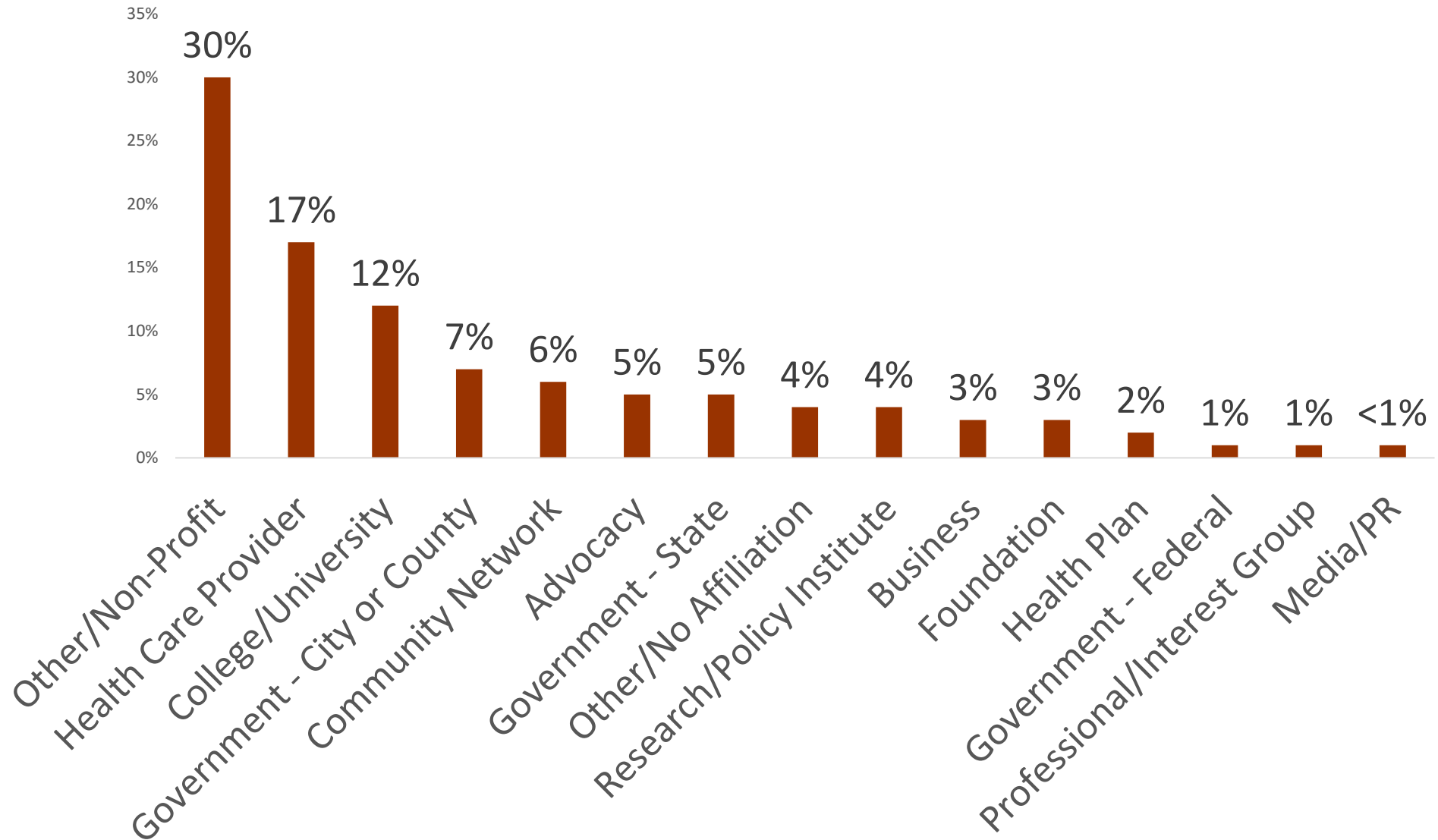



# Maryjoan Ladden, PhD, RN, FAAN

Senior Program Officer  
Robert Wood Johnson Foundation

[rwjf.org](http://rwjf.org)



## **Jeffrey Moy**

Senior Program Manager  
Culture of Health Leaders Program  
National Collaborative for Health Equity

[nationalcollaborative.org](http://nationalcollaborative.org)

## Poll #2

**Did you apply for the Culture of Health Leaders program last year?**

- A. Yes
- B. No



## **Tara Hacker**

Senior Program Manager  
Culture of Health Leaders Program  
CommonHealth ACTION

[commonhealthaction.org](https://commonhealthaction.org)

## Poll #3

**Which type of organization do you work or volunteer for?**

1. Public Sector (Government)
2. Private Sector (for-profit)
3. Social Sector (non-profit/NGO)
4. Social Enterprise/Benefit Corporation



## **Jeffrey Moy**

Senior Program Manager  
Culture of Health Leaders Program  
National Collaborative for Health Equity

[nationalcollaborative.org](http://nationalcollaborative.org)

# Q&A Feature

1. Type your question in the **Q&A box**
2. Select **Ask: All Panelists**
3. Send

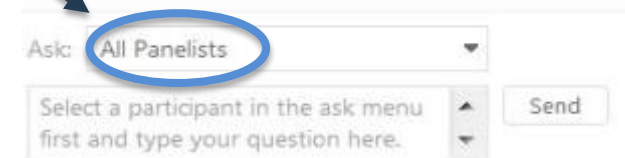
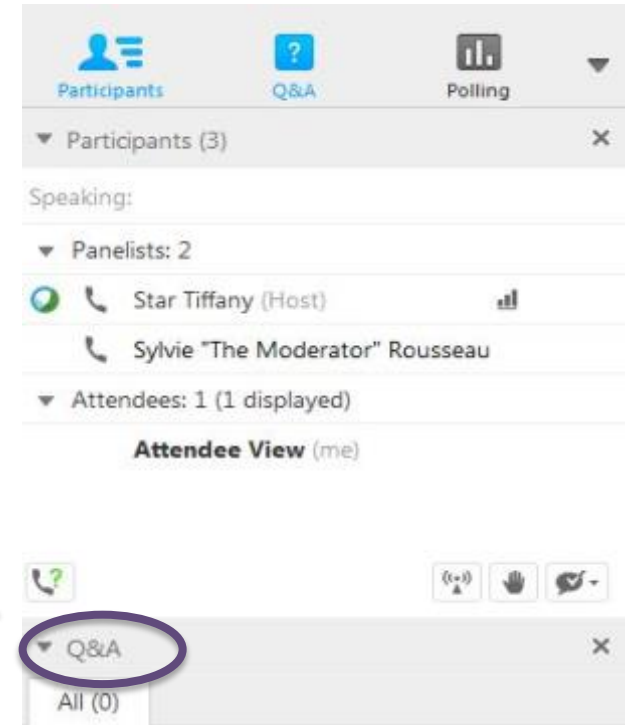





**Willene  
Hare**



**Maryjoan  
Ladden**



**Tara  
Hacker**



**Jeffrey  
Moy**

# Q&A Feature

1. Type your question in the **Q&A box**
2. Select **Ask: All Panelists**
3. Send

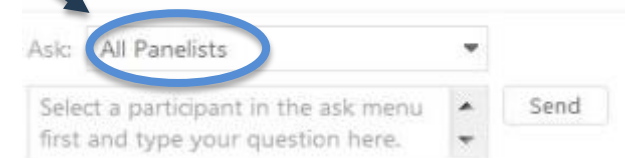
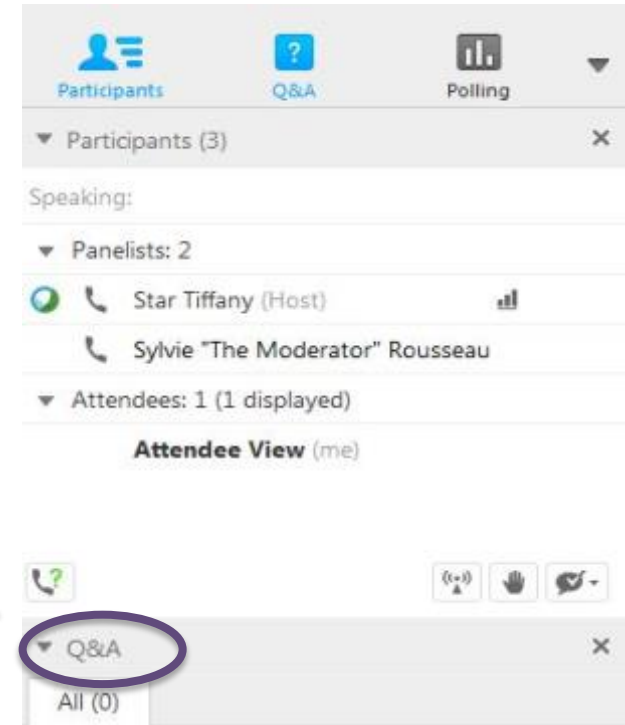

# Thank you to our moderator & presenters!



**Willene  
Hare**



**Maryjoan  
Ladden**



**Tara  
Hacker**



**Jeffrey  
Moy**

# Thank you to our partners for today's event!



**Culture of Health Leaders is a program of the Robert Wood Johnson Foundation co-led by the National Collaborative for Health Equity and CommonHealth ACTION.**



**National Collaborative  
for Health Equity**

**WORKING WITH PEOPLE, PARTNERS, AND PURPOSE**



CommonHealth  
**ACTION**

# Culture of Health Leaders Applicant Web Forum

**Thank you for joining this Web Forum!**

The **recording** and **slides** will be available at  
**[Dialogue4Health.org](https://Dialogue4Health.org)**

Dialogue4Health

