

Pain in the Nation: The Drug, Alcohol and Suicide Crises and the Need for a National Resilience Strategy

May 1, 2018

10 AM – 11:30 AM Pacific

1 PM – 2:30 PM Eastern

Please close all applications except WebEx.

Audio trouble? Send us a question in the **Q&A** panel.

Technical trouble? Call WebEx at **1-866-229-3239**.

Closed captioning instructions will be provided.

Connect with us on **Twitter** [@Dialogue4Health](https://twitter.com/Dialogue4Health)

Audio



Audio is through your computer speakers or headphones

No sound?

→ Unmute and turn up your speaker volume

Still no sound? Call in.

→ Click the small telephone icon in the Participants panel to see dial-in information

Closed Captioning

To see real-time closed captioning:

1. Click to open **Media Viewer**



2. Click **Show/Hide Header**

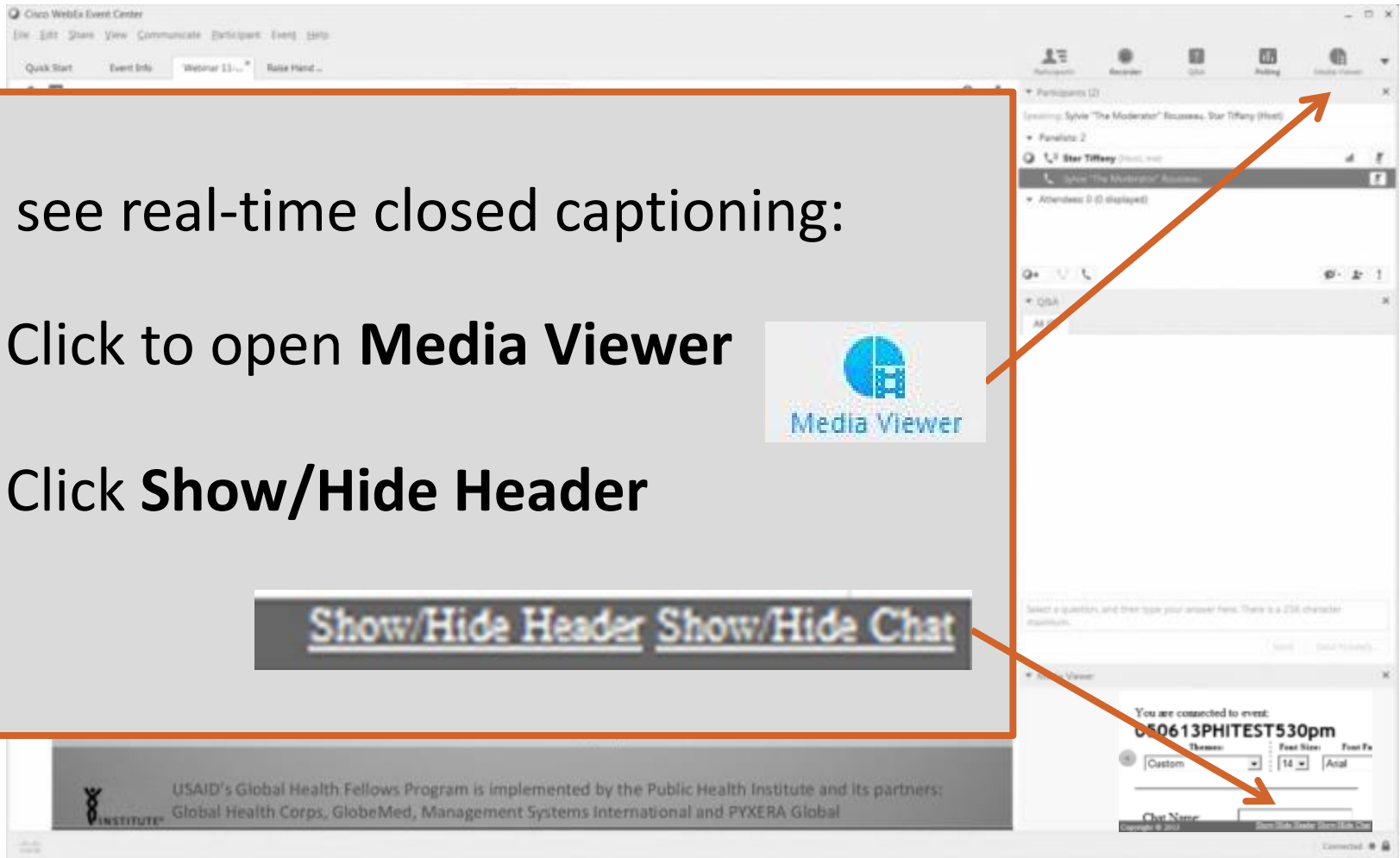
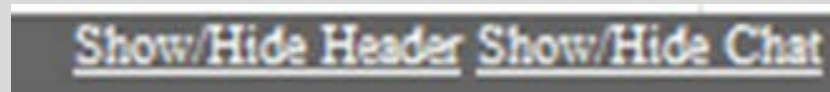

Q&A Feature

1. Type your question in the **Q&A box**
2. Select **Ask: All Panelists**
3. Click **Send**

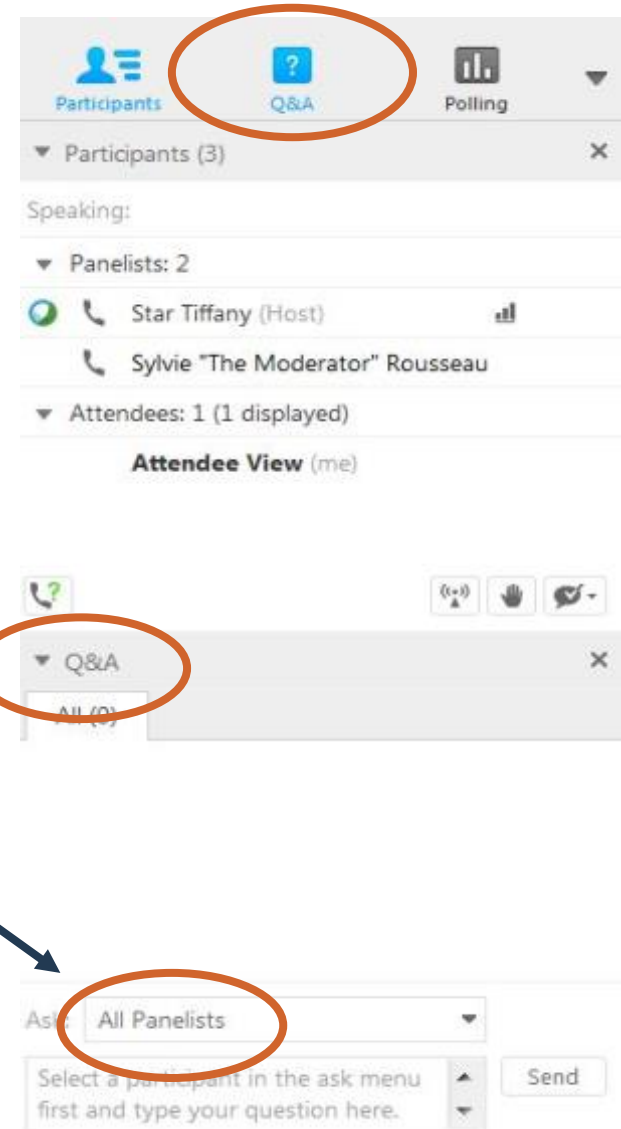

Polling Feature

Please:

1. Choose your **answer**

2. Click **Submit**

Participants Q&A **Polling**

Participants (3) ×

Q&A ×

Polling ×

Time elapsed: 0:46 Time limit: 1:30

Poll Questions:

1. Are you attending this Web Forum:

a. Individually

b. In a group of 2-5 people

c. In a group of 6-10 people

d. In a group of more than 10 people

Submit

Your answer may be recorded.

Poll #1

Are you attending this Web Forum:

- A. Individually
- B. In a group of 2-5 people
- C. In a group of 6-10 people
- D. In a group of more than 10 people



J. Nadine Gracia, MD, MSCE

Executive Vice President and Chief
Operating Officer
Trust for America's Health

tfah.org

About the Audience: Where You Are

- In all 50 US states, Washington DC, Puerto Rico, Australia, Canada, and India
- States with more than 15 registrants are:

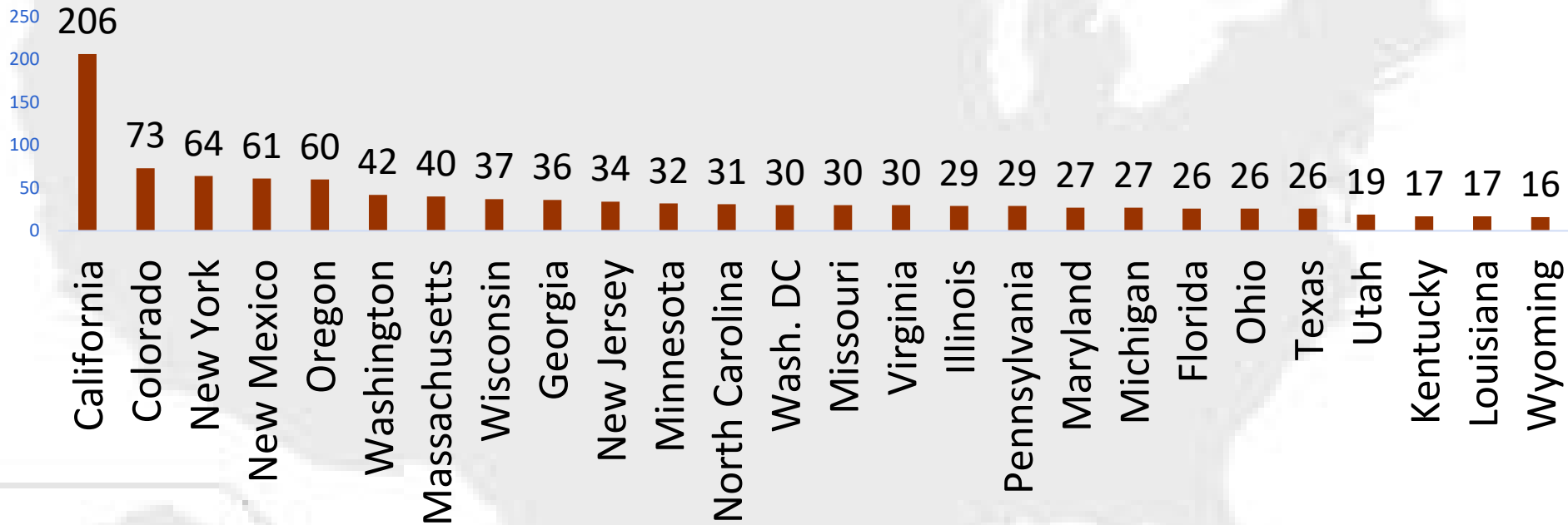

Poll #2

**What sector/industry best represents your sector?
(Check all that apply)**

- a. Advocacy
- b. Government
- c. Community-based
- d. Early Childhood
- e. Education
- f. Faith-based
- g. Health
- h. Non-profit
- i. Public health
- j. Other



Ben Miller, PsyD

Chief Strategy Officer
Well Being Trust

wellbeingtrust.org

Poll #3

Is your organization doing work around drug, alcohol, and suicide prevention? (Check all that apply)

- a. Drug
- b. Alcohol
- c. Suicide



Dayna Bowen Matthew, AB, JD

William L. Matheson and Robert M.
Morgenthau Distinguished Professor of Law
University of Virginia School of Law

content.law.virginia.edu



[bmc.org](https://www.bmc.org)

Michael Botticelli

Executive Director
Grayken Center for Addiction Medicine,
Boston Medical Center



Kat Allen

Coalition Coordinator
Partnership for Youth
Franklin Regional Council of
Governments

frcog.org

Poll #4

As you think about drug, alcohol, and suicide prevention and your community, what additional resources or support do you need to increase your work in this area? (Check all that apply)

- a. Increased understanding among leadership of the importance of drug, alcohol, and suicide prevention and the need to partner.
- b. Best practices/models/examples of drug, alcohol, and suicide prevention that are replicable.
- c. Ways to engage with other leaders/partners and elected officials around the country.
- d. A national resilience strategy.

Q&A Feature

1. Type your question in the **Q&A box**
2. Select **Ask: All Panelists**
3. Click **Send**

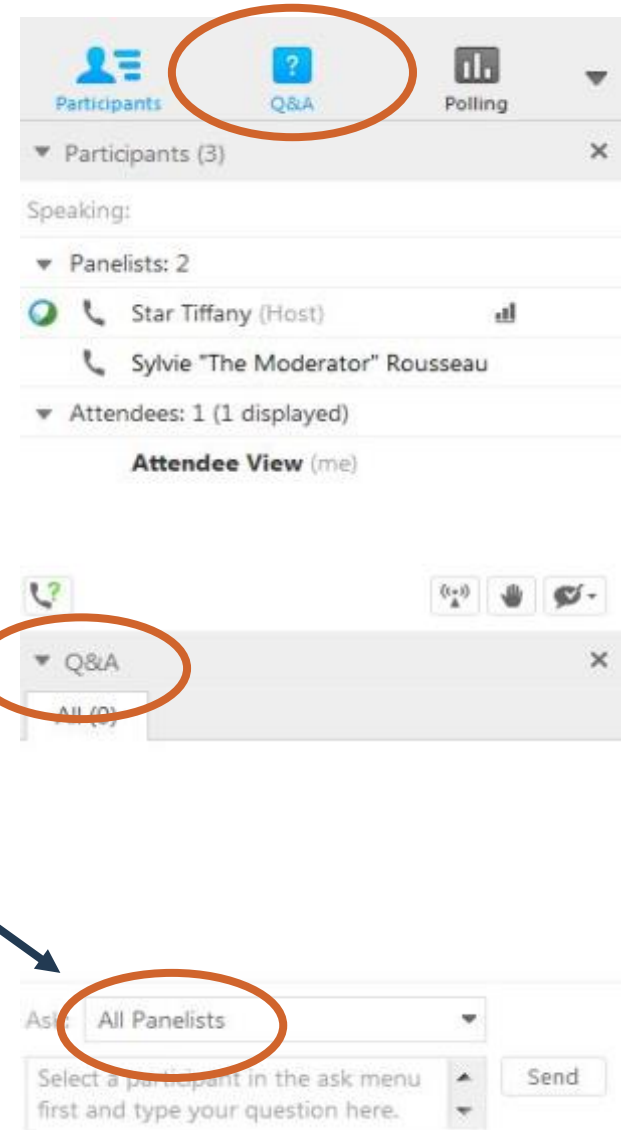



**J. Nadine
Gracia**



**Dayna
Bowen Matthew**



**Kat
Allen**



**Ben
Miller**



**Michael
Botticelli**

Thank you to today's panel!



**J. Nadine
Gracia**



**Dayna
Bowen Matthew**



**Kat
Allen**



**Ben
Miller**



**Michael
Botticelli**

Thank you to today's partner and sponsor!



**Pain in the Nation:
The Drug, Alcohol and Suicide Crises
and the Need for a National Resilience Strategy**

Thank you for joining this Web Forum!

The **recording** and **slides** will be available at
Dialogue4Health.org

Dialogue4Health

