

Digital Health Solutions to Advance Health & Well-Being for Vulnerable Populations

Thursday, August 18, 2016

10:00 AM – 11:30 AM Pacific

1:00 PM – 2:30 PM Eastern

Please close all applications except WebEx.

Audio difficulties? Send us a question in the **Q&A** panel.

Technical difficulties? Call WebEx at **1-866-229-3239**.

Connect with us: **Twitter** [@Dialogue4Health](https://twitter.com/Dialogue4Health) | **#DigitalHealthD4H**

Closed Captioning

To see real-time closed captioning:

1. Click to open **Media Viewer**



2. Click **Show/Hide Header**

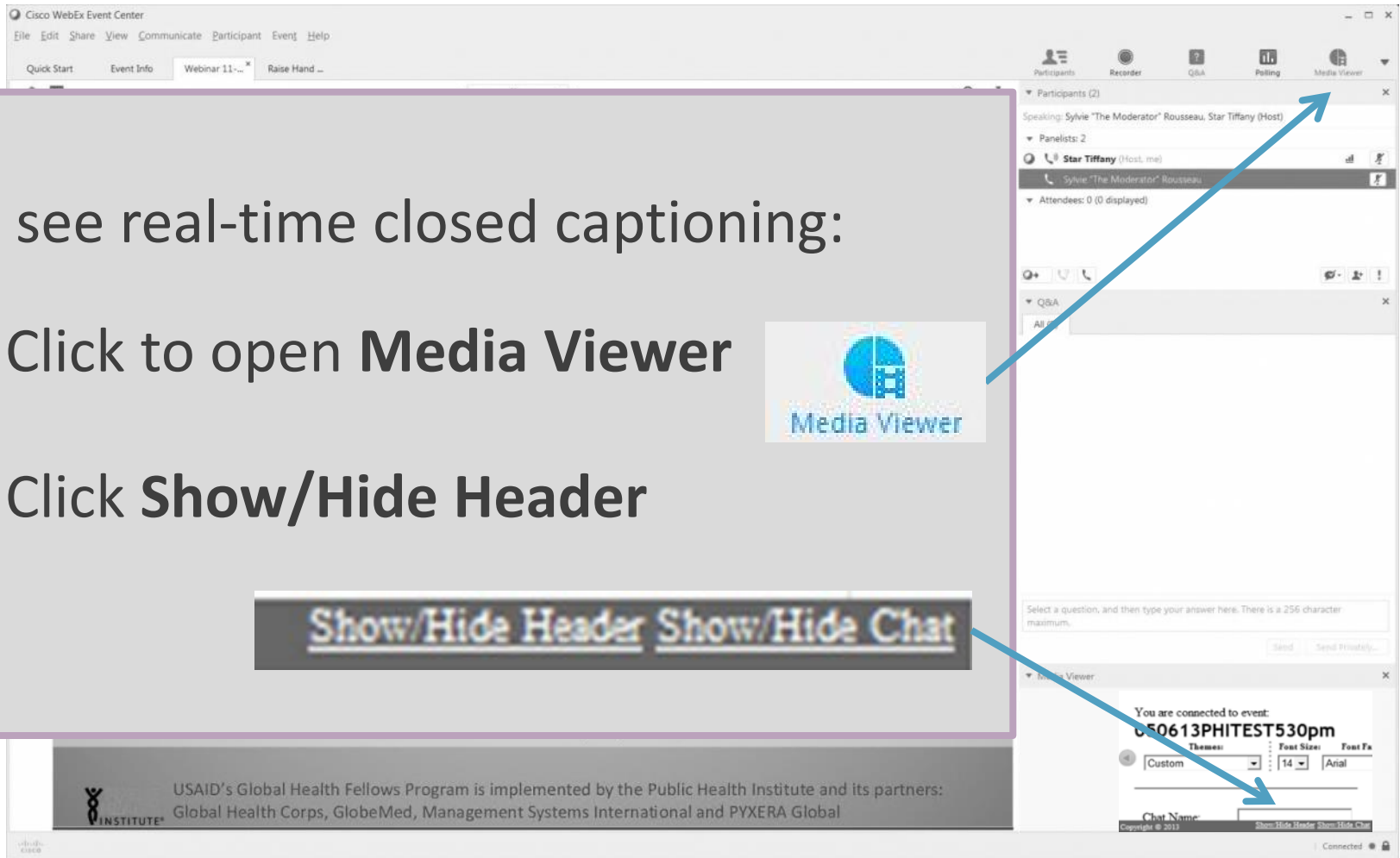
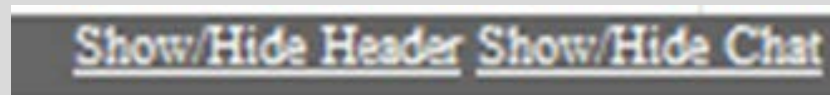

Q&A Feature

1. Type your question in the Q&A box
2. Select **Ask: All Panelists**
3. Send

The screenshot displays the Zoom meeting interface. At the top, there are three main navigation icons: 'Participants', 'Q&A', and 'Polling'. Below these, a 'Participants (3)' dropdown is visible. The 'Speaking' section shows two participants: 'Star Tiffany (Host)' and 'Sylvie "The Moderator" Rousseau'. The 'Attendees: 1 (1 displayed)' section shows 'Attendee View (me)'. A 'Q&A' box is open, showing 'All (0)'. The 'Ask:' dropdown menu is set to 'All Panelists', and a 'Send' button is visible. The 'Q&A' box is highlighted with a purple oval, and the 'All Panelists' dropdown is highlighted with a blue oval. Arrows from the text instructions point to these elements.

Polling Feature

Please:

1. Choose your **answer**
2. Click **Submit**

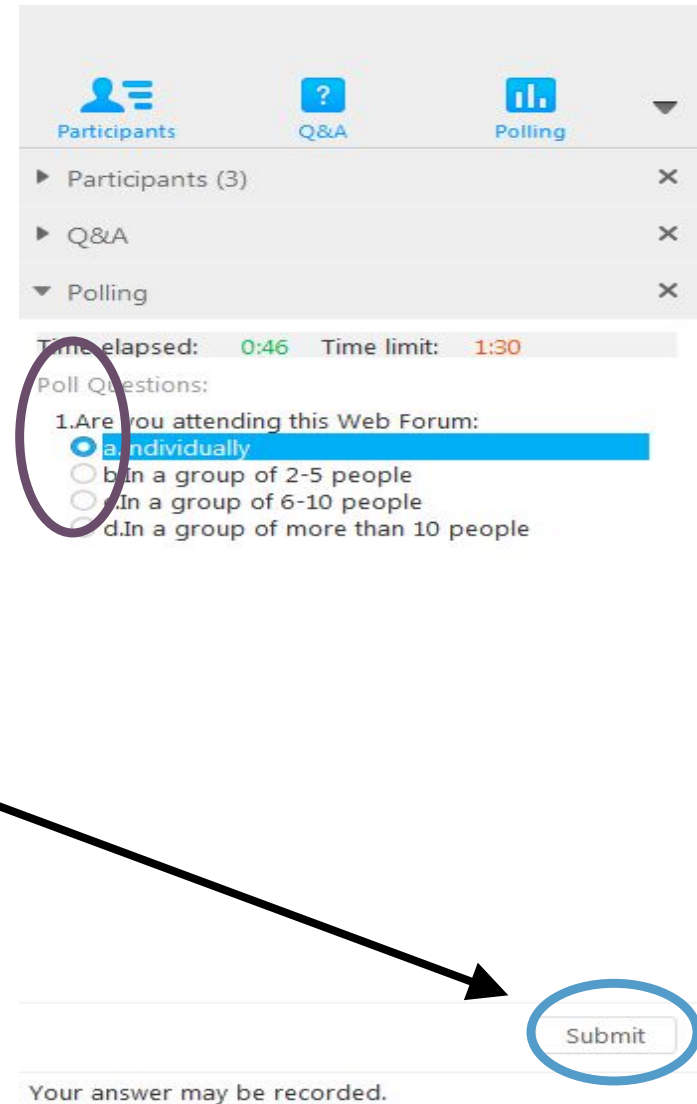

The screenshot shows a web interface with a top navigation bar containing three icons: 'Participants' (person icon), 'Q&A' (question mark icon), and 'Polling' (bar chart icon). Below the navigation bar is a list of sections: 'Participants (3)', 'Q&A', and 'Polling'. The 'Polling' section is expanded, showing a poll question: '1. Are you attending this Web Forum:'. The question has four radio button options: 'a. Individually', 'b. In a group of 2-5 people', 'c. In a group of 6-10 people', and 'd. In a group of more than 10 people'. The 'a. Individually' option is selected and highlighted with a blue bar. A purple circle highlights the question text. Below the poll question is a 'Submit' button, which is circled in blue. At the bottom of the interface, there is a message: 'Your answer may be recorded.'

Poll #1

Are you attending this Web Forum:

- a) Individually
- b) In a group of 2-5 people
- c) In a group of 6-10 people
- d) In a group of more than 10 people

Our Presenters



Andrew Broderick



Dan Gillette



Valerie Steinmetz



Center for
Innovation and Technology
in Public Health



Center for
Technology and Aging

About the Audience: Where You Are

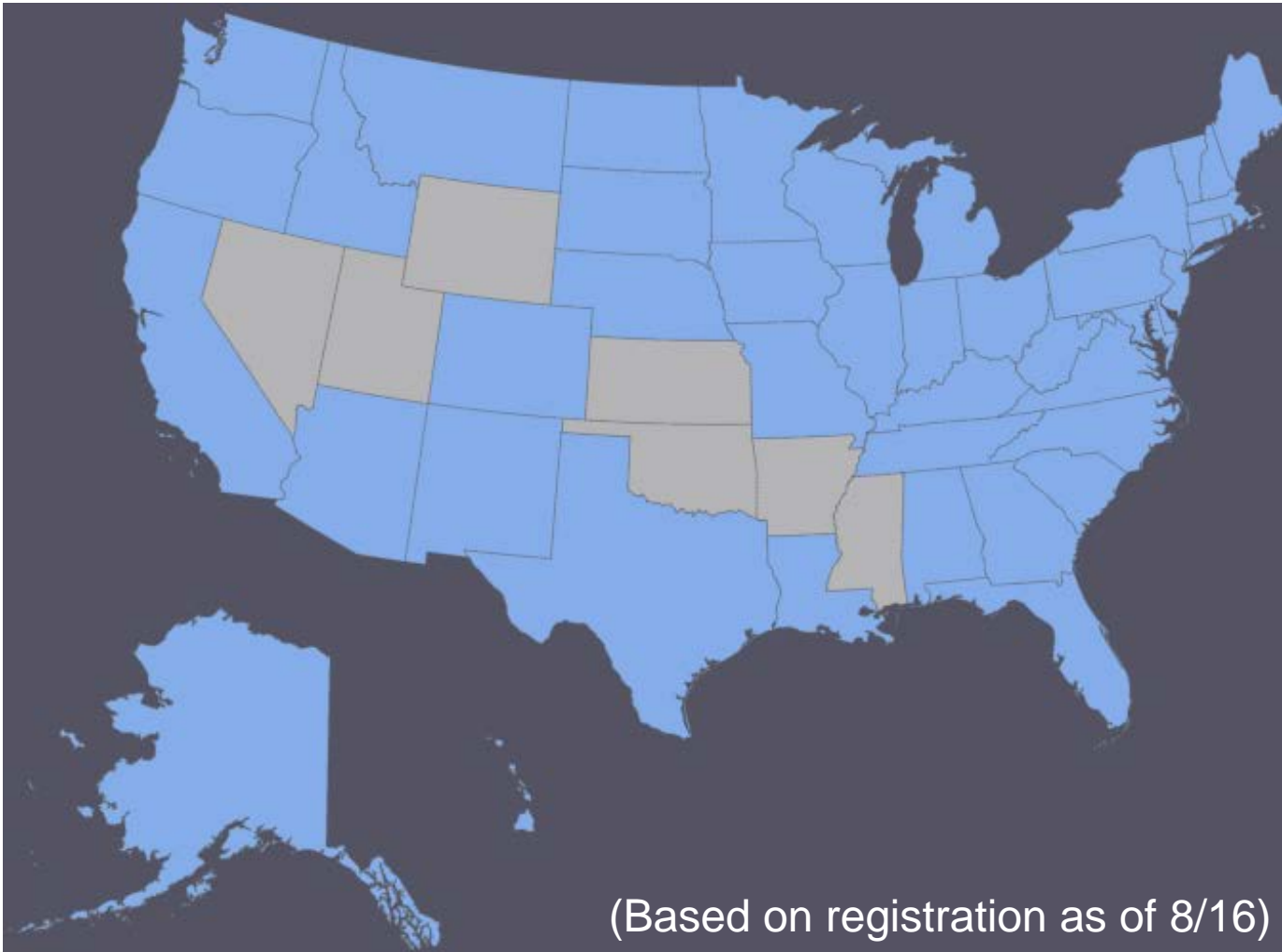

- + Australia
- + Canada
- + Colombia
- + Mexico
- + Puerto Rico
- + UK

(Based on registration as of 8/16)

About the Audience: Work

Are you part of an organization that works directly with vulnerable populations?

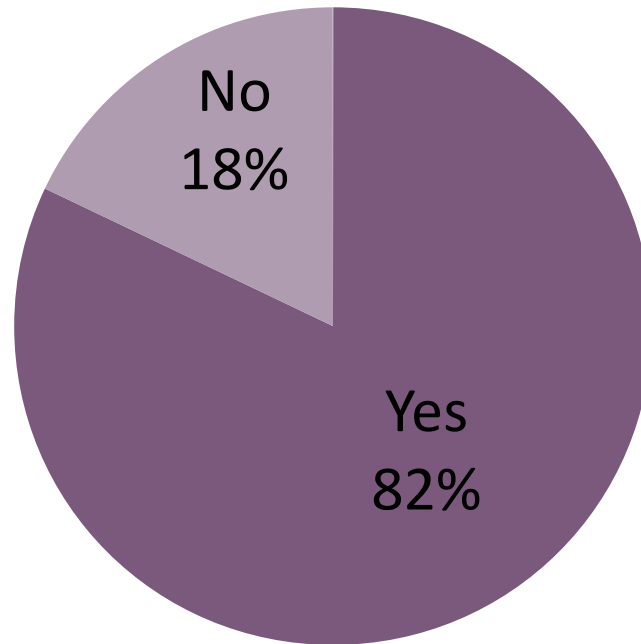

(Based on registration as of 8/16)

Q&A Feature

1. Type your question in the Q&A box
2. Select **Ask: All Panelists**
3. Send

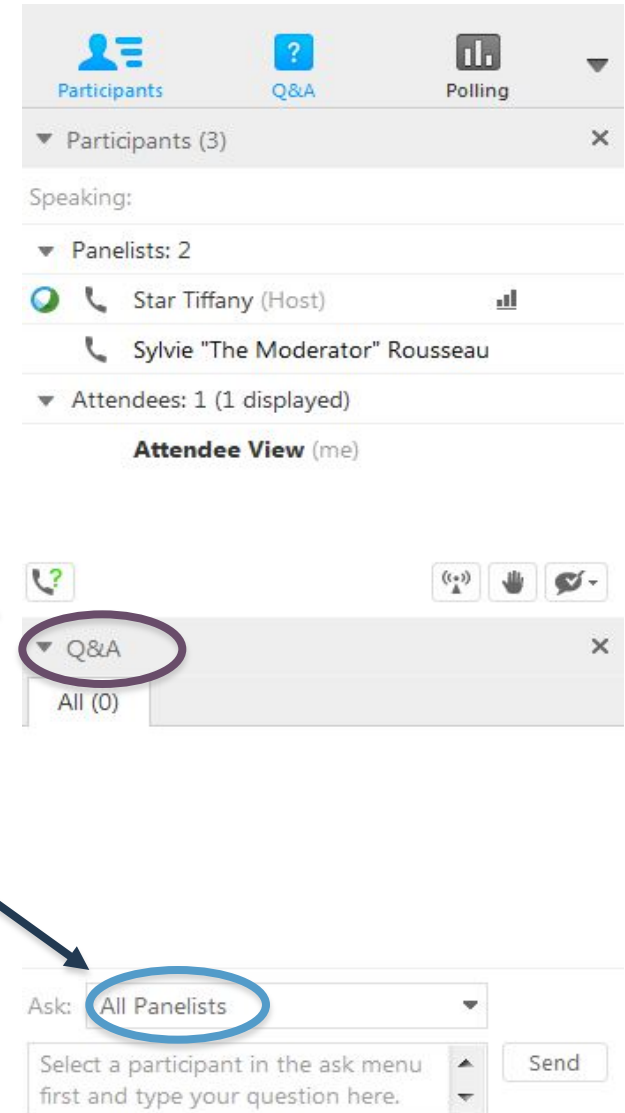

Thank you Andrew, Dan, & Valerie!



Andrew Broderick



Dan Gillette



Valerie Steinmetz



Thank you to our sponsor:



Digital Health Solutions to Advance Health & Well-Being for Vulnerable Populations

Thank you for joining our Web Forum!

The **Recording** and **Slides** will be available at

www.Dialogue4Health.org

Visit us on **Facebook**

www.facebook.com/Dialogue4Health