

Sharing a Public Health Oriented Model Local Ordinance for Marijuana Regulation

December 15, 2017

Noon to 1:30 Pacific

3 PM to 4:30 PM Eastern

Please close all applications except WebEx.

Audio trouble? Send us a question in the **Q&A** panel.

Technical trouble? Call WebEx at **1-866-229-3239**.

Closed captioning instructions will be provided.

Connect with us on **Twitter** [@Dialogue4Health](https://twitter.com/Dialogue4Health)

Audio

Audio is through your computer speakers or headphones

No sound?

→ Unmute and turn up your speaker volume

Still no sound? Call in.

→ Send us a note through **Q&A** for instructions

Closed Captioning

To see real-time closed captioning:

1. Click to open **Media Viewer**



2. Click **Show/Hide Header**

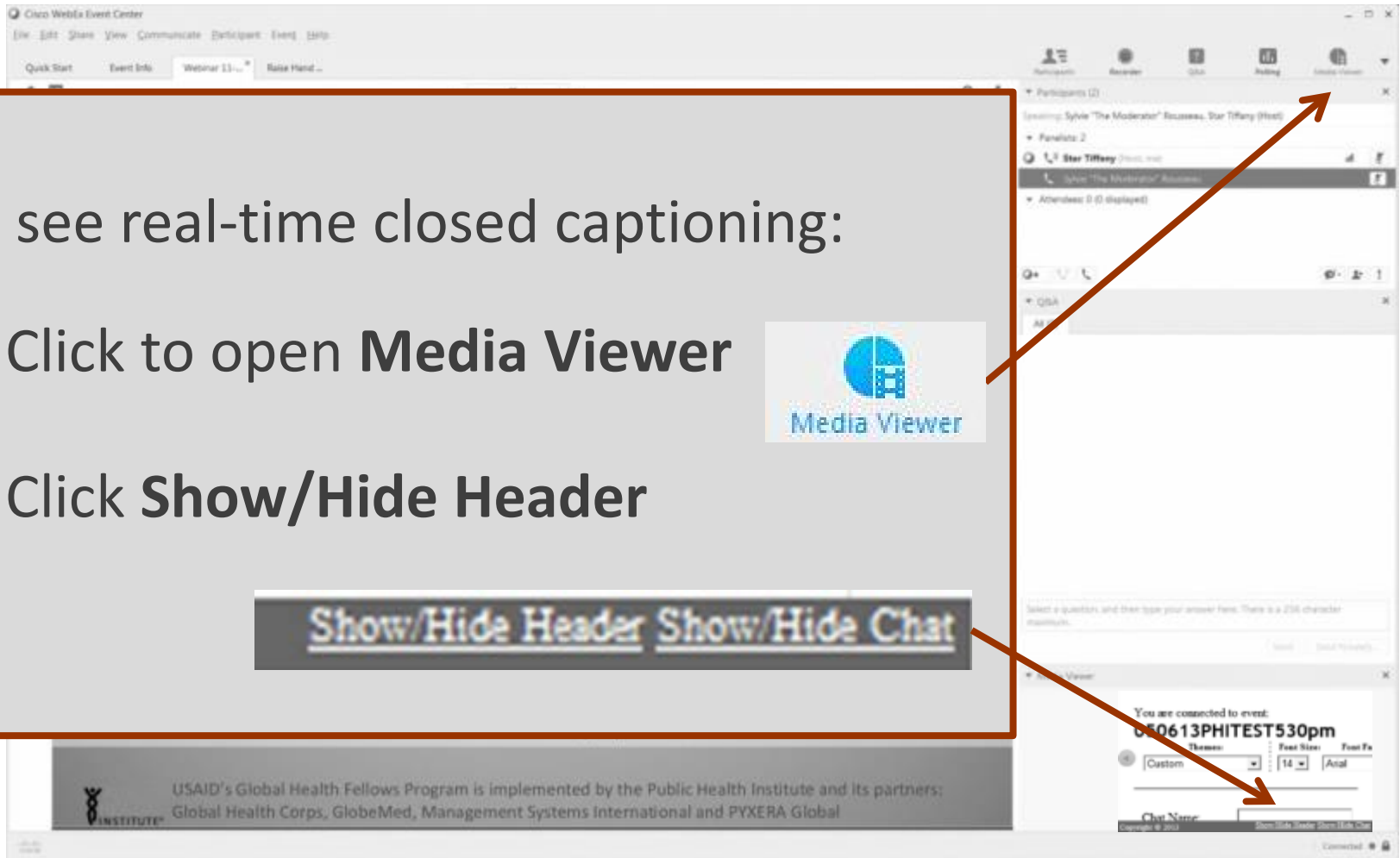
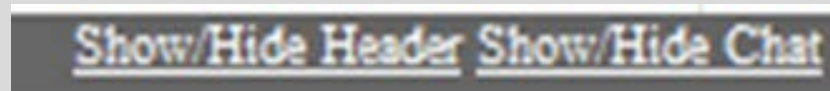

Q&A Feature

1. Type your question in the **Q&A box**
2. Select **Ask: All Panelists**
3. Click **Submit**

The image shows a screenshot of a Q&A interface. At the top, there are three icons: 'Participants', 'Q&A', and 'Polling'. The 'Q&A' icon is circled in orange. Below this, there is a 'Participants (3)' section. Underneath, there is a 'Speaking:' section, followed by 'Panelists: 2' which lists 'Star Tiffany (Host)' and 'Sylvie "The Moderator" Rousseau'. Below that is 'Attendees: 1 (1 displayed)'. The current view is 'Attendee View (me)'. At the bottom, there is a 'Q&A' section with a dropdown menu set to 'All (0)'. This dropdown is also circled in orange. Below the dropdown, there is a text input field with a placeholder 'Select a participant in the ask menu first and type your question here.' and a 'Send' button. The 'Send' button is also circled in orange. Arrows from the text on the left point to these three elements: the Q&A icon, the dropdown menu, and the Send button.

Polling Feature

Please:

1. Choose your **answer**
2. Click **Submit**

The screenshot shows a web interface with a top navigation bar containing three icons: a person icon labeled 'Participants', a question mark icon labeled 'Q&A', and a bar chart icon labeled 'Polling'. The 'Polling' icon is circled in orange. Below the navigation bar, there are three expandable sections: 'Participants (3)', 'Q&A', and 'Polling'. The 'Polling' section is expanded, showing a question: '1. Are you attending this Web Forum:'. The question has four radio button options: 'a. Individually' (which is selected and highlighted in blue), 'b. In a group of 2-5 people', 'c. In a group of 6-10 people', and 'd. In a group of more than 10 people'. The 'a. Individually' option is circled in orange. Below the question, there is a 'Submit' button, which is also circled in orange. At the bottom of the interface, there is a text box containing the text 'Your answer may be recorded.'

Poll #1

Are you attending this Web Forum:

- A. Individually
- B. In a group of 2-5 people
- C. In a group of 6-10 people
- D. In a group of more than 10 people



Alisa Padon, PhD

Research Scientist
Public Health Institute

[PHI.org](https://www.phi.org)

About the Audience: Where You Are

- In 43 US states, Guam, and Canada
- These states have more than 5 audience members:

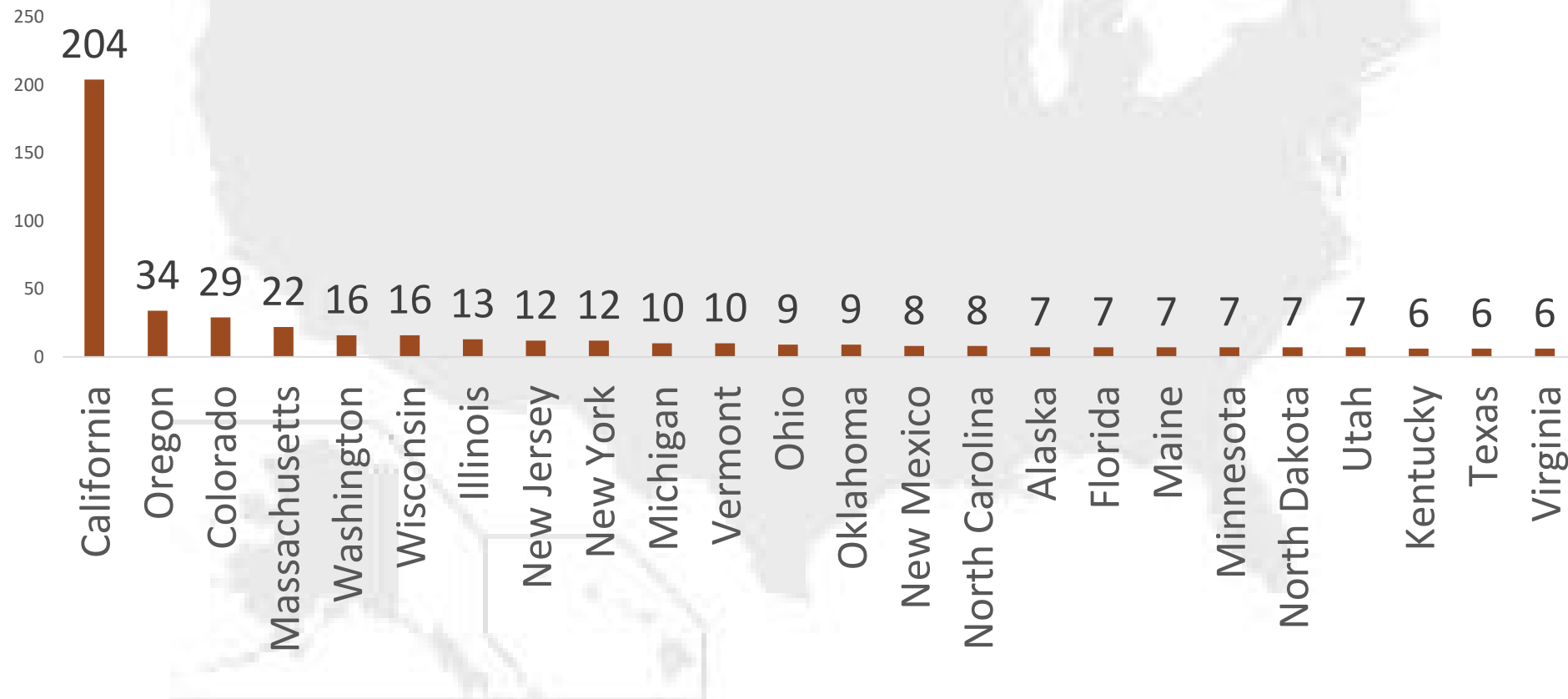

About the Audience: Work Sectors

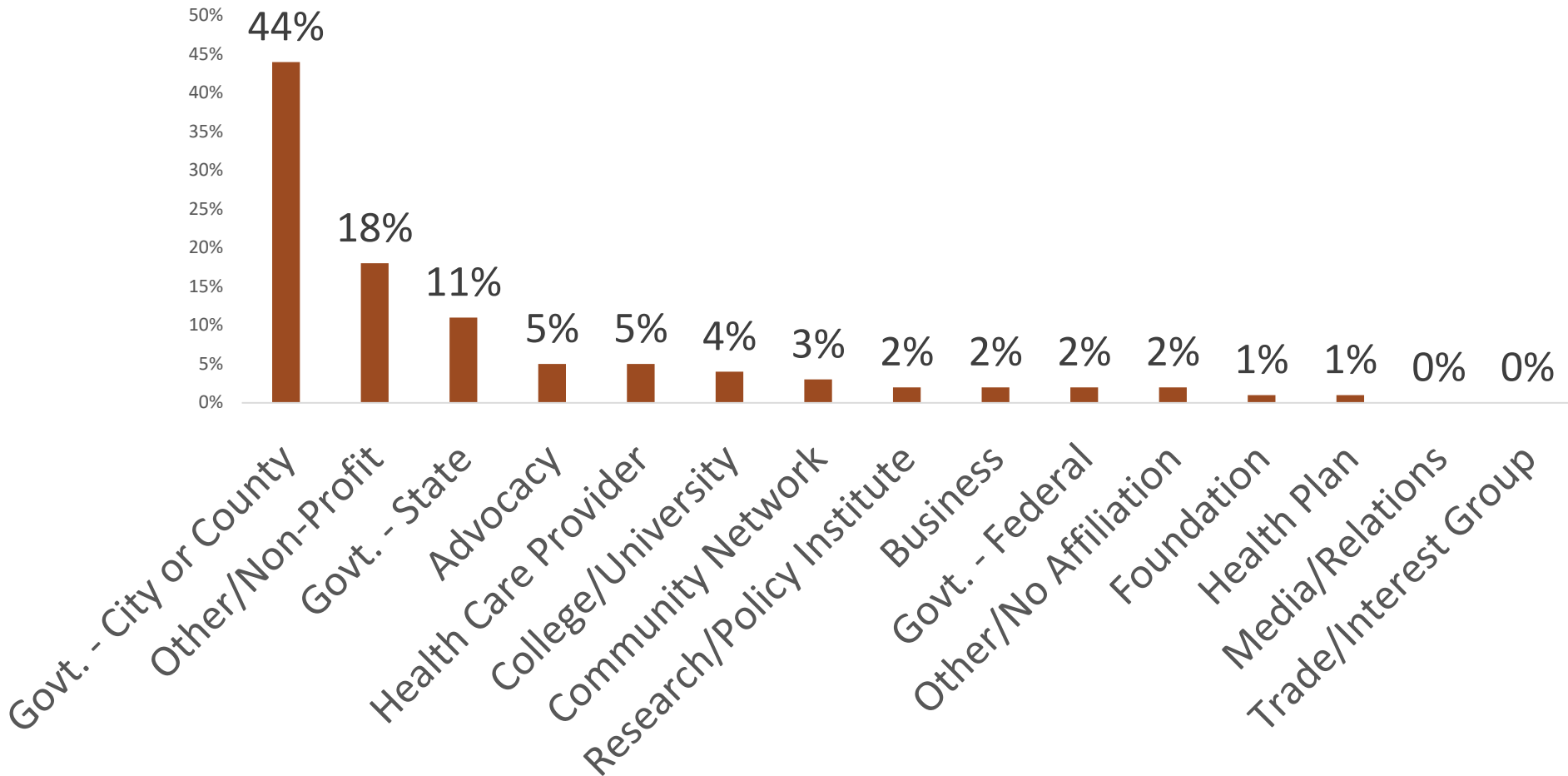



Lynn Silver, MD, MPH, FAAP

Director, Getting it Right from the Start:
Local Regulation of Recreational
Marijuana & Senior Advisor
Public Health Institute

[PHI.org](https://www.phi.org)

Poll #2

Should the number of legal marijuana retailers be limited?

- A. Yes
- B. No



Leslie Zellers, JD

Consultant

Public Good Law Center

Poll #3

1. Should marijuana infused beverages like soda or tea be prohibited?

- A. Yes
- B. No
- C. Don't know

2. Should we restrict the sale of high potency products like shatter or wax?

- A. Yes
- B. No
- C. I have no idea what those are



Ted Mermin, JD

Executive Director
Public Good Law Center

publicgoodlaw.org



Alisa Padon, PhD

Research Scientist
Public Health Institute

[PHI.org](https://www.phi.org)

Questions?

1. Type your question in the **Q&A box**
2. Select **Ask: All Panelists**
3. Click **Send**

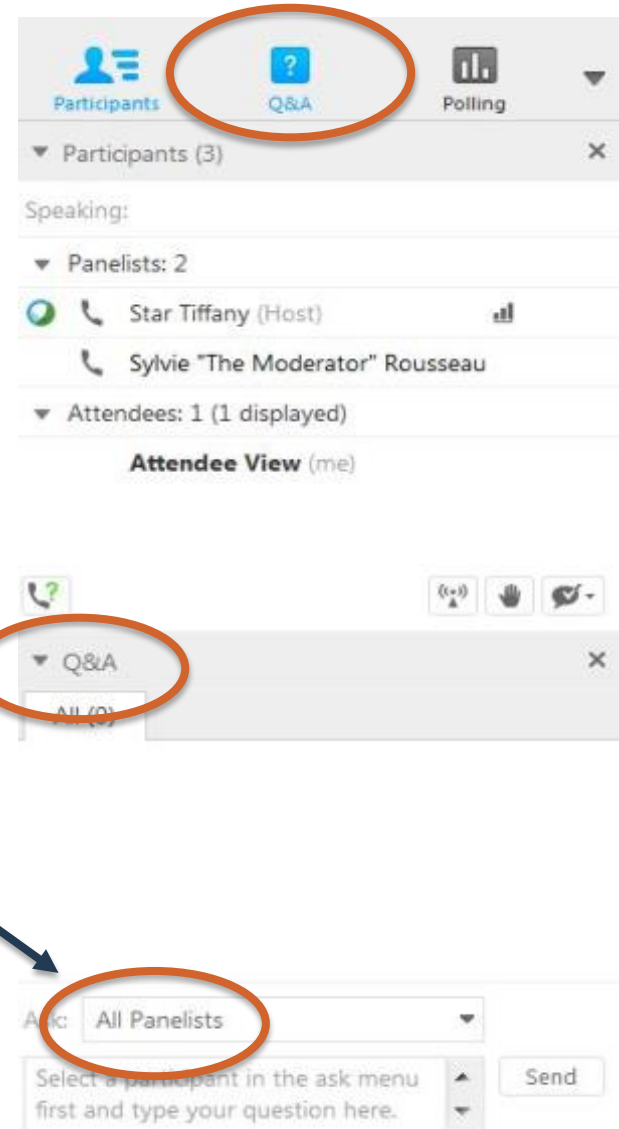



**Alisa
Padon**



**Leslie
Zellers**



**Lynn
Silver**



**Ted
Mermin**

Thank you to our host & presenters!



**Alisa
Padon**



**Lynn
Silver**



**Leslie
Zellers**



**Ted
Mermin**

Thank you to our partner and sponsor:

Getting it Right from the Start:
Local Regulation of Recreational Marijuana



Sharing a Public Health Oriented Model Local Ordinance for Marijuana Regulation

Thank you for joining our Web Forum!

**The Recording and Slides will be available by next week at
Dialogue4Health.org**

Join the **Dialogue4Health LinkedIn Group** at
[tinyurl.com/D4HGroup](https://www.tinyurl.com/D4HGroup)
