

Take Action: Raising Your Voice in Support of Public Health and Access to Care

June 14, 2017

Noon – 1 PM Pacific

3 – 4 PM Eastern

Please close all applications except WebEx.

Audio trouble? Send us a question in the **Q&A** panel.

Technical trouble? Call WebEx at **1-866-229-3239**.

Closed captioning instructions will be provided.

Connect with us on **Twitter** [@Dialogue4Health](https://twitter.com/Dialogue4Health) | **#DefendPublicHealth**

Closed Captioning

To see real-time closed captioning:

1. Click to open **Media Viewer**



2. Click **Show/Hide Header**

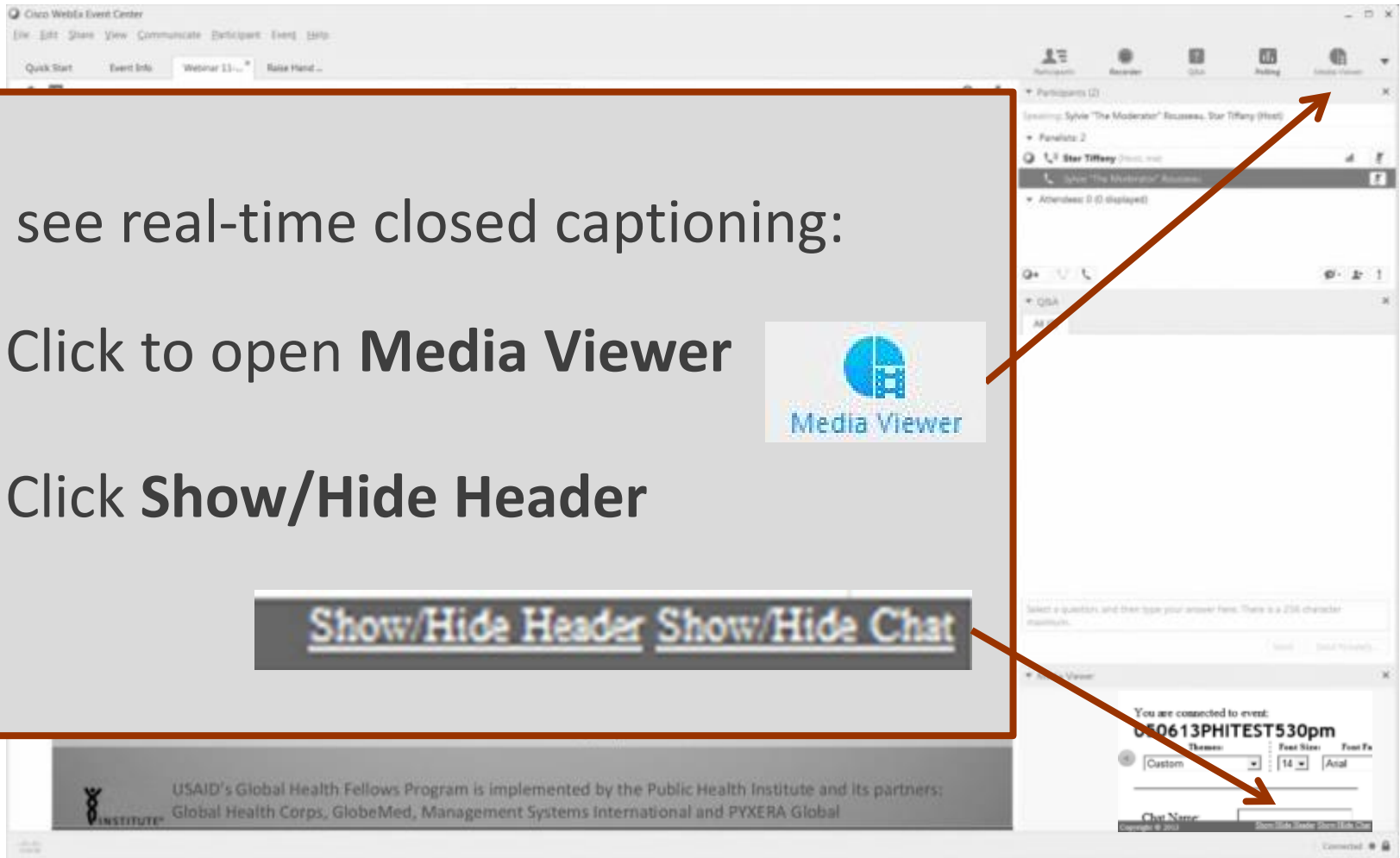
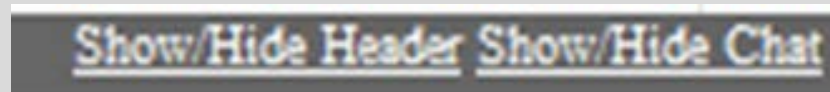

Q&A Feature

1. Type your question in the **Q&A box**
2. Select **Ask: All Panelists**
3. Click **Submit**

The screenshot shows the Zoom meeting interface. At the top, the 'Q&A' icon is circled in orange. Below it, the 'Q&A' dropdown menu is open, and the 'All Panelists' option is circled in orange. The 'Submit' button is also visible.

Polling Feature

Please:

1. Choose your **answer**
2. Click **Submit**

Participants Q&A **Polling**

Participants (3) x

Q&A x

Polling x

Time elapsed: 0:46 Time limit: 1:30

Poll Questions:

1. Are you attending this Web Forum:

a. Individually

b. In a group of 2-5 people

c. In a group of 6-10 people

d. In a group of more than 10 people

Submit

Your answer may be recorded.

Poll #1

Are you attending this Web Forum:

- A. Individually
- B. In a group of 2-5 people
- C. In a group of 6-10 people
- D. In a group of more than 10 people



Matthew Marsom

Vice President, Public Policy and Programs
Public Health Institute

[PHI.org](https://www.phi.org)

About the Audience: Where You Are

- In 49 US states, Puerto Rico, and Canada
- These states have more than 10 audience members:

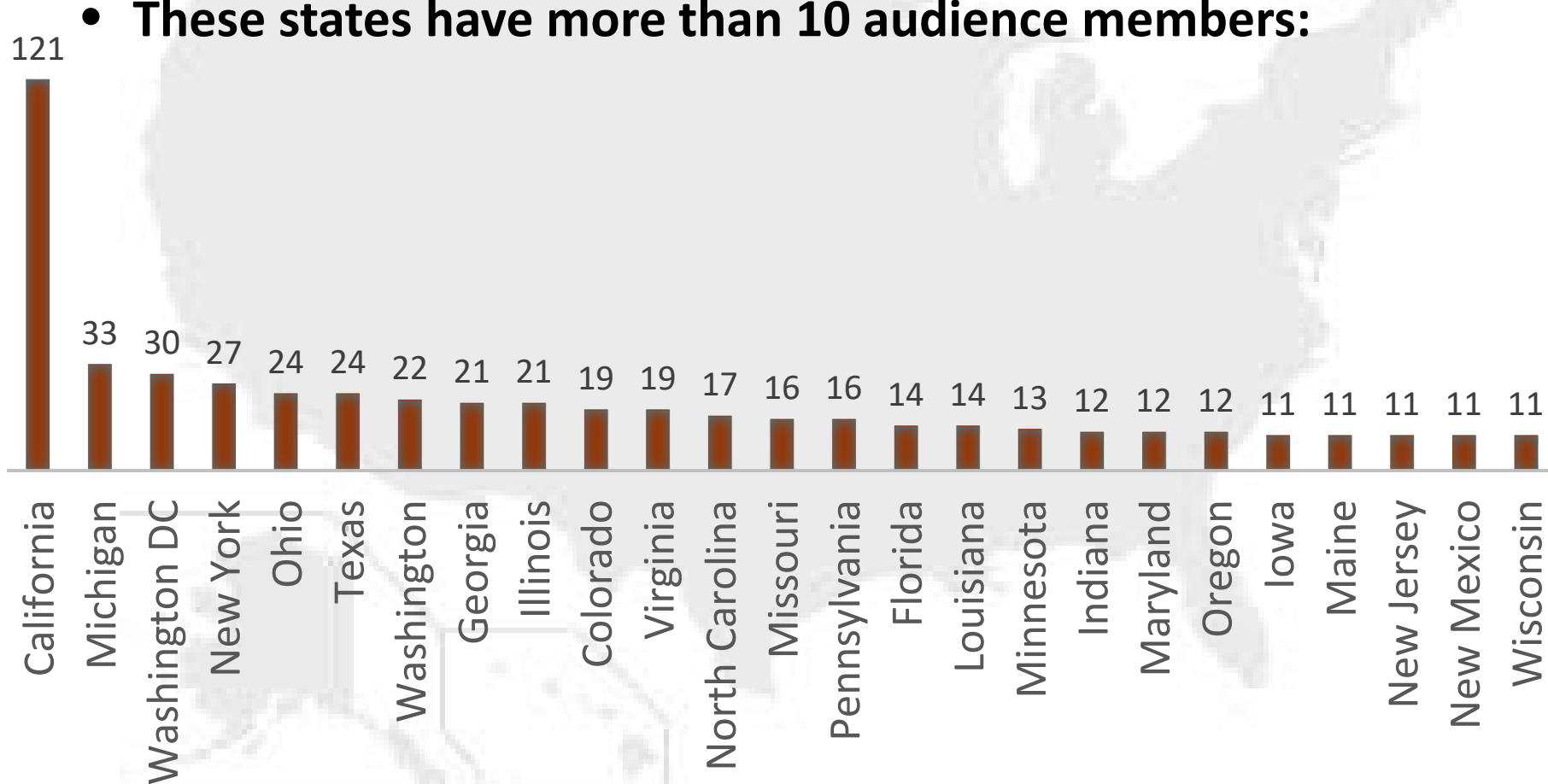

About the Audience: Work Sectors

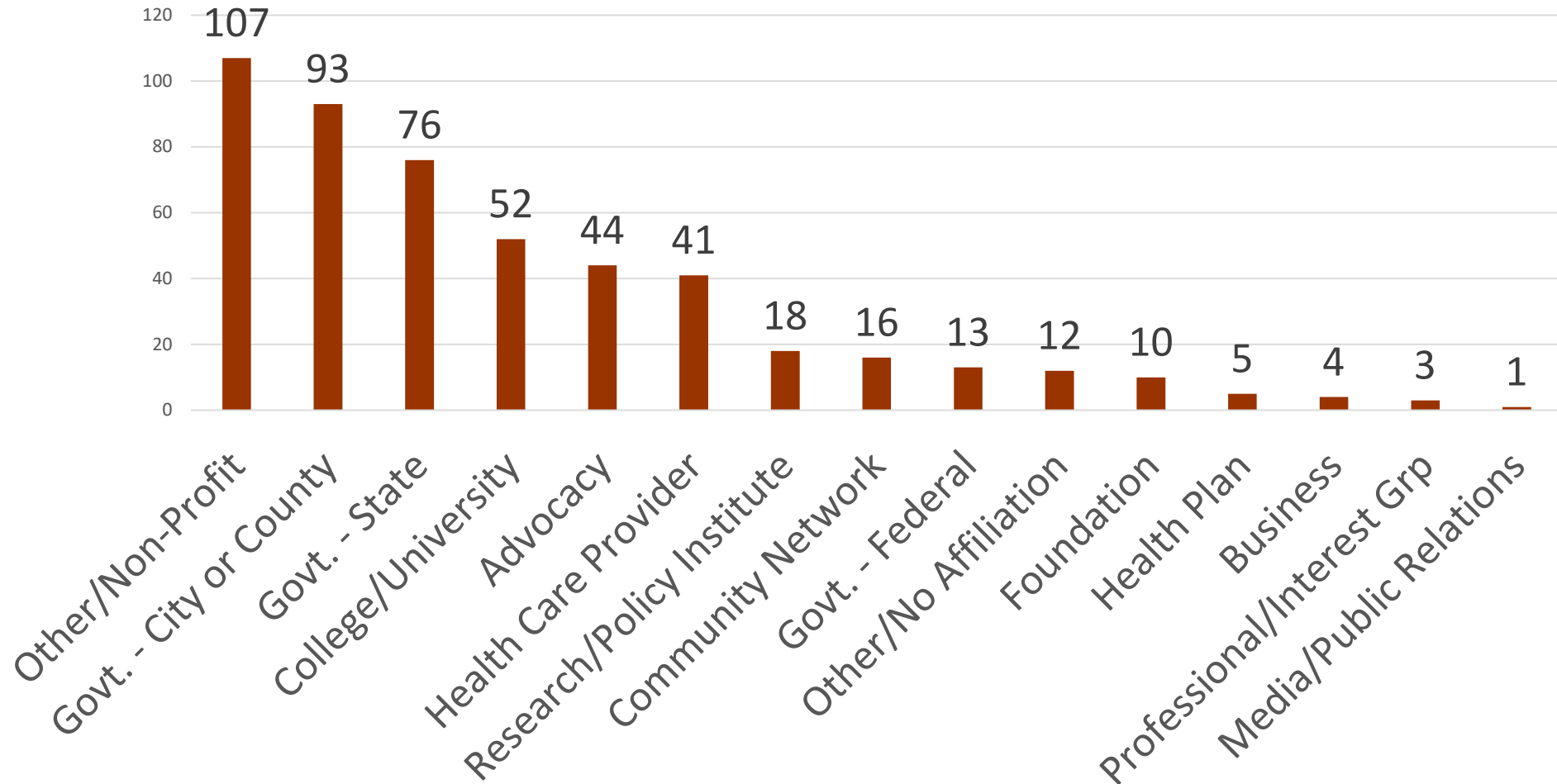

Poll #2

What sector/industry best represents your work?

- A. Advocacy
- B. Community-based
- C. Education
- D. Faith-based
- E. Government
- F. Health
- G. Public health
- H. Other



Claire McAndrew

Director of Campaign Strategy
Families USA

[FamiliesUSA.org](https://www.familiesusa.org)



Tiffany Kaszuba

Vice President
CRD Associates

DC-CRD.com



Donald Hoppert

Director of Government Relations
American Public Health Association

[APHA.org](https://www.apha.org)

Poll #3

Do you want to partner with organizations from today's web forum to reach out to policymakers on June 15 for a virtual advocacy day in support of prevention?

- A. Yes, please send me information about this
- B. No

Questions?

1. Type your question in the **Q&A box**
2. Select **Ask: All Panelists**
3. Click **Send**

The screenshot shows a meeting interface with a top navigation bar containing 'Participants', 'Q&A', and 'Polling'. Below this, there are sections for 'Participants (3)', 'Speaking:', 'Panelists: 2' (listing 'Star Tiffany (Host)' and 'Sylvie "The Moderator" Rousseau'), and 'Attendees: 1 (1 displayed)'. The 'Attendee View (me)' section is visible. A 'Q&A' panel is open, showing a 'Q&A' dropdown menu and a 'Send' button. The 'Ask' dropdown menu is set to 'All Panelists'. The 'Q&A' icon in the top bar and the 'Q&A' dropdown in the panel are circled in orange. Arrows point from the text instructions to these elements.

Prevention Advocacy Priorities and Resources to Help With Your Advocacy

Priorities

- PPHF is the top priority.
- People are healthier with access to affordable health care, including the full range of clinical preventive services.
- Creating places for public health partners to work together across the political spectrum on some unifying issues in the ACA talks.
- Prepare to defend the CDC budget, especially at risk programs.

Resources

- June 15th Take Action: [RSVP to send a message to your members of Congress to #ProtectPrevention](#)
- Thunderclap: [Support #ProtectPrevention Thunderclap](#)
- [Prevention and Public Health Fund Detailed Information](#)
- [The Potential Impact of the President's Proposed FY 2018 Budget – By The Numbers](#)
- REACH Sign-on [Letter](#): [Sign here](#)

Thank you to our presenters!



**Claire
McAndrew**



**Tiffany
Kaszuba**



**Don
Hoppert**

Thank you to our partners!

**American Public Health Association
Prevention Institute
Public Health Institute
Trust for America's Health**



Take Action: Raising Your Voice in Support of Public Health and Access to Care

Thank you for joining our Web Forum!

The **Recording** and **Slides** will be available next week at
Dialogue4Health.org

Join the **Dialogue4Health LinkedIn Group** at
tinyurl.com/D4HGroup
